

Light source fitting

5905339082206

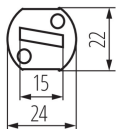
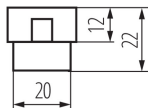

### GENERAL DATA:

**Colour:** grey

### TECHNICAL DATA:

**Rated voltage [V]:** 250 AC

**Rated current [A]:** 2

**Cap:** G9

**IP class:** 00

### LOGISTIC DATA:

**Unit of measurement:** unit

**Packaging method:** 50

**Number of units in the secondary packaging:** 50

**Number of units in the packaging:** 1000

**Net unit weight [g]:** 16

**Grammage [g]:** 17.8

**Length of a unit pack [cm]:** 11

**Width of a unit pack [cm]:** 3

**Height of a unit pack [cm]:** 14

**Weight of a cardboard box [kg]:** 17.8

**Width of a cardboard box [cm]:** 31

**Height of a cardboard box [cm]:** 26

**Length of a cardboard box [cm]:** 46

**Volume of a cardboard box [m<sup>3</sup>]:** 0.037076

### ADDITIONAL INFORMATION:

- Maximum permissible holder temperature 250°C for BR-GZ10, HLDR-GZ10, HLDR-R7S, for other models - 180°C
- Maximum permissible current for BR-GZ10, HLDR-GZ10, HLDR-G9 - 2A, for HLDR-R7S - 6A, for HLDR-GX5.3 - 5A
- BR-GZ10 equipped with a support